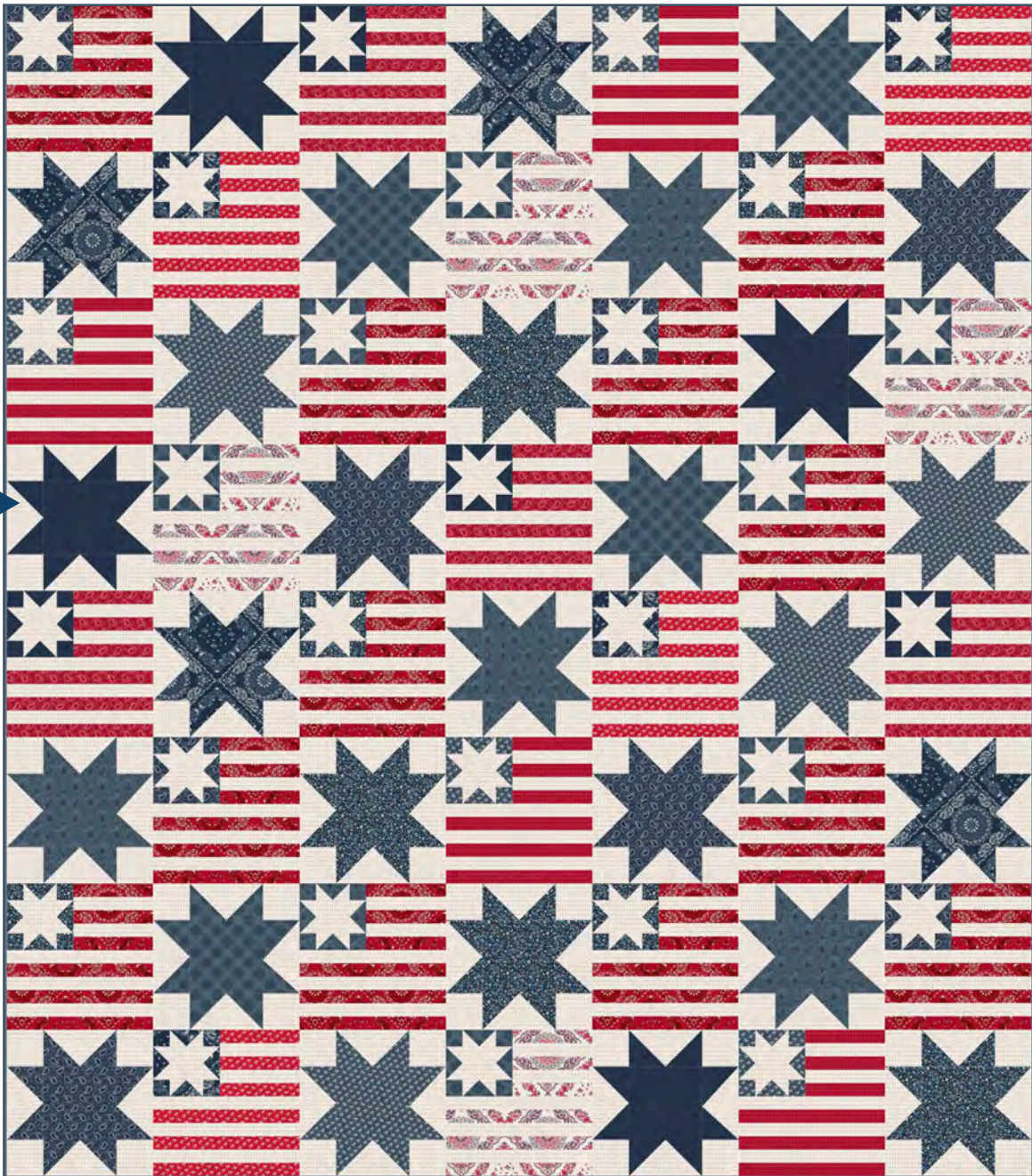

INTERMEDIATE
SKILL

Stars on the Hudson

Designed by Wendy Sheppard
Featuring *Hudson* by *Whistler Studios*

SIZE: 77" x 88"

FREE
PATTERN





THIS IS A DIGITAL REPRESENTATION OF THE QUILT TOP, FABRIC MAY VARY.



Stars on the Hudson

Notes: Mark and store cutting pieces according to the block they have been assigned to, as this will ease the piecing process.

WOF = Width of Fabric

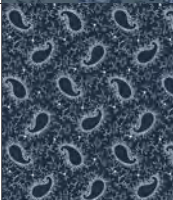
KEY	FABRIC	SKU	YD	CUTTING INSTRUCTIONS
A		52198A-2 Navy	3/4	STAR BLOCKS: (3) 3-1/4" x WOF strips; subcut (32) 3-1/4" squares. (1) 6" x WOF strip; subcut (4) 6" squares. FLAG BLOCKS: (2) 1-3/4" x WOF strips; subcut (16) 1-3/4" x 3" rectangles and (16) 1-3/4" squares.
B		52198A-5 Red	1	FLAG BLOCKS: (16) 1-1/2" x WOF strips; subcut (36) 1-1/2" x 11-1/2" and (36) 1-1/2" x 6-1/2" strips. Note: (1) 1-1/2" x WOF strip will cut (3) 1-1/2" x 11-1/2" and (1) 1-1/2" x 6-1/2" rectangles. Use (12) 1-1/2" x WOF strips to cut (36) 1-1/2" x 11-1/2" and (12) 1-1/2" x 6-1/2" rectangles. Use remaining (4) 1-1/2" x WOF strips to cut remaining (24) 1-1/2" x 6-1/2" rectangles.
C		52198A-1 Linen	3/8	FLAG BLOCKS: (6) 1-1/2" x WOF strips; subcut (12) 1-1/2" x 11-1/2" and (12) 1-1/2" x 6-1/2" strips.
D		52953-1 Linen	5	STAR BLOCKS: (28) 3-1/4" x WOF strips; subcut (112) 3-1/4" x 6" rectangles and (112) 3-1/4" squares. FLAG BLOCKS: (33) 1-1/2" x WOF strips; subcut (84) 1-1/2" x 11-1/2" and (56) 1-1/2" x 6-1/2" strips. (10) 1-3/4" x WOF strips; subcut (224) 1-3/4" squares. (3) 3" x WOF strips; subcut (28) 3" squares.
E		52948-7 Slate	3/4	STAR BLOCKS: (3) 3-1/4" x WOF strips; subcut (32) 3-1/4" squares. (1) 6" x WOF strip; subcut (4) 6" squares. FLAG BLOCKS: (2) 1-3/4" x WOF strips; subcut (16) 1-3/4" x 3" rectangles and (16) 1-3/4" squares.
F		52952-2 Navy	3/4	STAR BLOCKS: (3) 3-1/4" x WOF strips; subcut (32) 3-1/4" squares. (1) 6" x WOF strip; subcut (4) 6" squares. FLAG BLOCKS: (2) 1-3/4" x WOF strips; subcut (16) 1-3/4" x 3" rectangles and (16) 1-3/4" squares.

PROJECT DISCLAIMER: Every effort has been made to ensure that all projects are error free. All the information is presented in good faith, however, no warranty can be given nor results guaranteed. Therefore, we assume no responsibility nor damages that may occur when referring to this pattern. When errors are brought to our attention, we make every effort to correct and post a revision as soon as possible. We suggest you check windhamfabrics.com for pattern updates and to test the pattern prior to making the project. Test templates first, before cutting all the pieces. Free projects are not for resale.



Stars on the Hudson

WOF = Width of Fabric

KEY	FABRIC	SKU	YD	CUTTING INSTRUCTIONS
G		52950-7 Slate INCLUDES BINDING	1-3/8	<p>BINDING: (9) 2-1/4" x WOF strips.</p> <p>STAR BLOCKS: (3) 3-1/4" x WOF strips; subcut (32) 3-1/4" squares. (1) 6" x WOF strip; subcut (4) 6" squares.</p> <p>FLAG BLOCKS: (3) 1-3/4" x WOF strips; subcut (16) 1-3/4" x 3" rectangles and (16) 1-3/4" squares.</p>
H		52953-5 Red	3/8	<p>FLAG BLOCKS: (6) 1-1/2" x WOF strips; subcut (12) 1-1/2" x 11-1/2" and (12) 1-1/2" x 6-1/2" strips.</p>
I		52952-5 Red		
J		52947-2 Navy	3/4	<p>STAR BLOCKS: (3) 3-1/4" x WOF strips; subcut (32) 3-1/4" squares. (1) 6" x WOF strip; subcut (4) 6" squares.</p> <p>FLAG BLOCKS: (2) 1-3/4" x WOF strips; subcut (16) 1-3/4" x 3" rectangles and (16) 1-3/4" squares.</p>
K		52951-7 Slate		
L		52953-2 Navy		
M		52951-5 Red	3/8	<p>FLAG BLOCKS: (6) 1-1/2" x WOF strips; subcut (12) 1-1/2" x 11-1/2" and (12) 1-1/2" x 6-1/2" strips.</p>
		Backing	5-3/8	Batting 83" x 94" piece.



Stars on the Hudson

STAR BLOCKS

- Flying Geese Units:** Draw a diagonal line on the wrong side of (2) **K** 3-1/4" squares. Place (1) square, right side together (RST), at a corner of (1) **D** 3-1/4" x 6" rectangle. Sew on drawn line. Trim 1/4" away from sewn line. Open and press to reveal (1) **K** corner triangle. Repeat with another **K** 3-1/4" square at the opposite corner of the same **D** rectangle to complete (1) flying geese unit. Make (4).

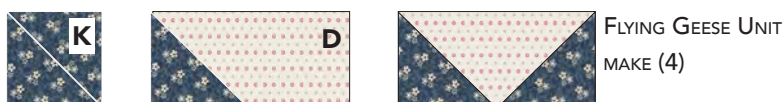

- Sew (2) flying geese units to the opposite sides of (1) **K** 6" square to make a row unit.
- Sew (2) **D** 3-1/4" squares to the opposite short sides of (1) 3-1/4" x 6" flying geese unit to make a row unit. Make (2) row units.
- Sew together row units to complete (1) Star Block. Make (4). Square to 11-1/2".

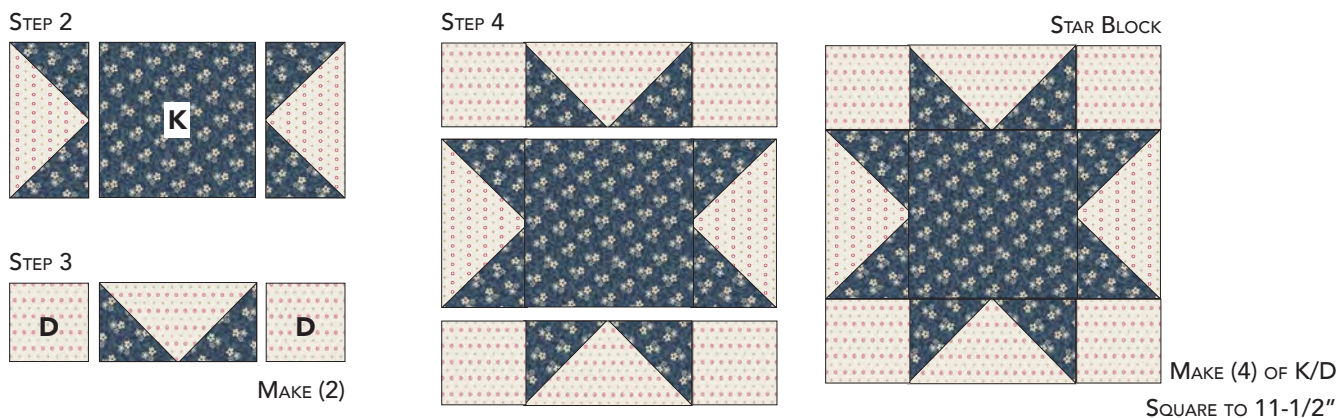

- Using fabric **D**, make (4) Star Blocks for each of the following combinations:

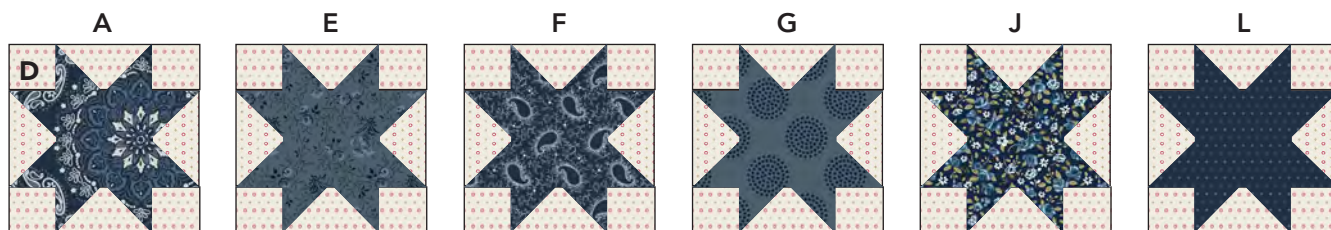



Stars on the Hudson

FLAG BLOCKS

Star Unit

- 6. Flying Geese Unit:** Repeat Step 1 using (2) **D** 1-3/4" squares and (1) **F** 1-3/4" x 3" rectangle. Make (4).
7. Sew (2) flying geese units to the opposite sides of (1) **D** 3" square to make a row unit.
8. Sew (1) **F** 1-3/4" square to each side of (1) flying geese unit to make a row unit. Make (2).
9. Sew together row units to complete (1) **Star Unit**, measuring 5-1/2" square.

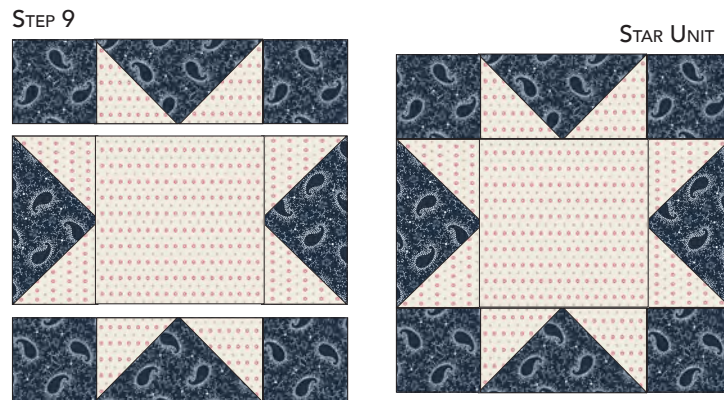
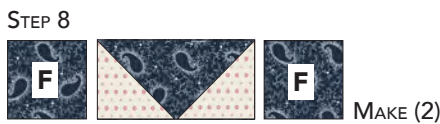
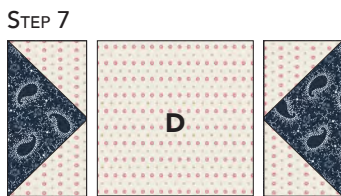
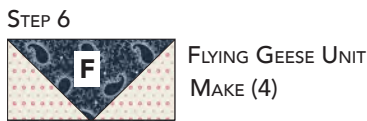

MEASURES 5-1/2" SQUARE

10. Sew together (3) **B** 1-1/2" x 6-1/2" rectangles and (2) **D** 1-1/2" x 6-1/2" rectangles as shown. Sew unit to the right of **Star Unit**. Unit measures 5-1/2" x 11-1/2".
11. Sew together (3) **B** 1-1/2" x 11-1/2" rectangles and (3) **D** 1-1/2" x 11-1/2" rectangles and add to the bottom of previously sewn section to complete (1) **Flag Block**. Make (4). Square to 11-1/2".

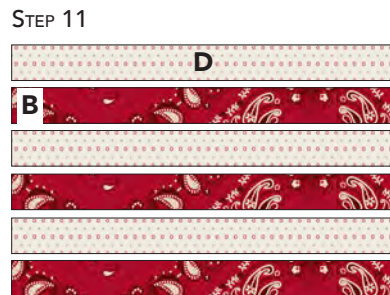
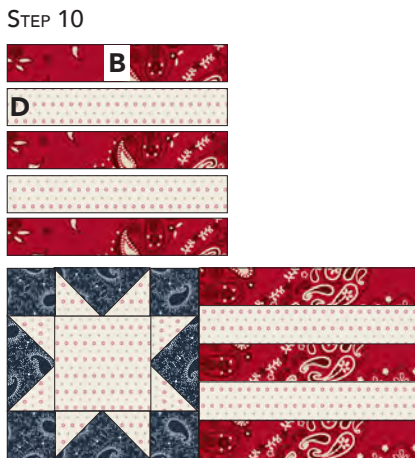



Stars on the Hudson

12. Make (4) Flag Blocks for each of the following fabric combinations:



QUILT TOP ASSEMBLY

Pieced Rows

13. Rows 1, 3, 5 and 7: Arrange and sew together (4) Flag Blocks and (3) Star Blocks.

Rows 2, 4, 6 and 8: Arrange and sew together (4) Star Blocks and (3) Flag Blocks.

Use Quilt Diagram on Page 6 as a reference.

Row 1: F/D/B, L/D, L/D/I, A/D, K/D/H, G/D, A/D/M

Row 2: A/D, A/D/M, G/D, G/D/C, E/D, J/D/B, F/D

Row 3: K/D/H, K/D, E/D/B, J/D, F/D/B, L/D, G/D/C

Row 4: L/D, G/D/C, F/D, L/D/I, G/D, E/D/B, K/D

Row 5: L/D/I, A/D, J/D/B, E/D, A/D/M, K/D, L/D/I

Row 6: E/D, F/D/B, J/D, K/D/H, F/D, E/D/B, A/D

Row 7: J/D/B, G/D, E/D/B, J/D, J/D/B, E/D, F/D/B

Row 8: F/D, A/D/M, K/D, G/D/C, L/D, K/D/H, J/D

14. Sew pieced rows together to complete quilt top.



Stars on the Hudson

QUILT DIAGRAM

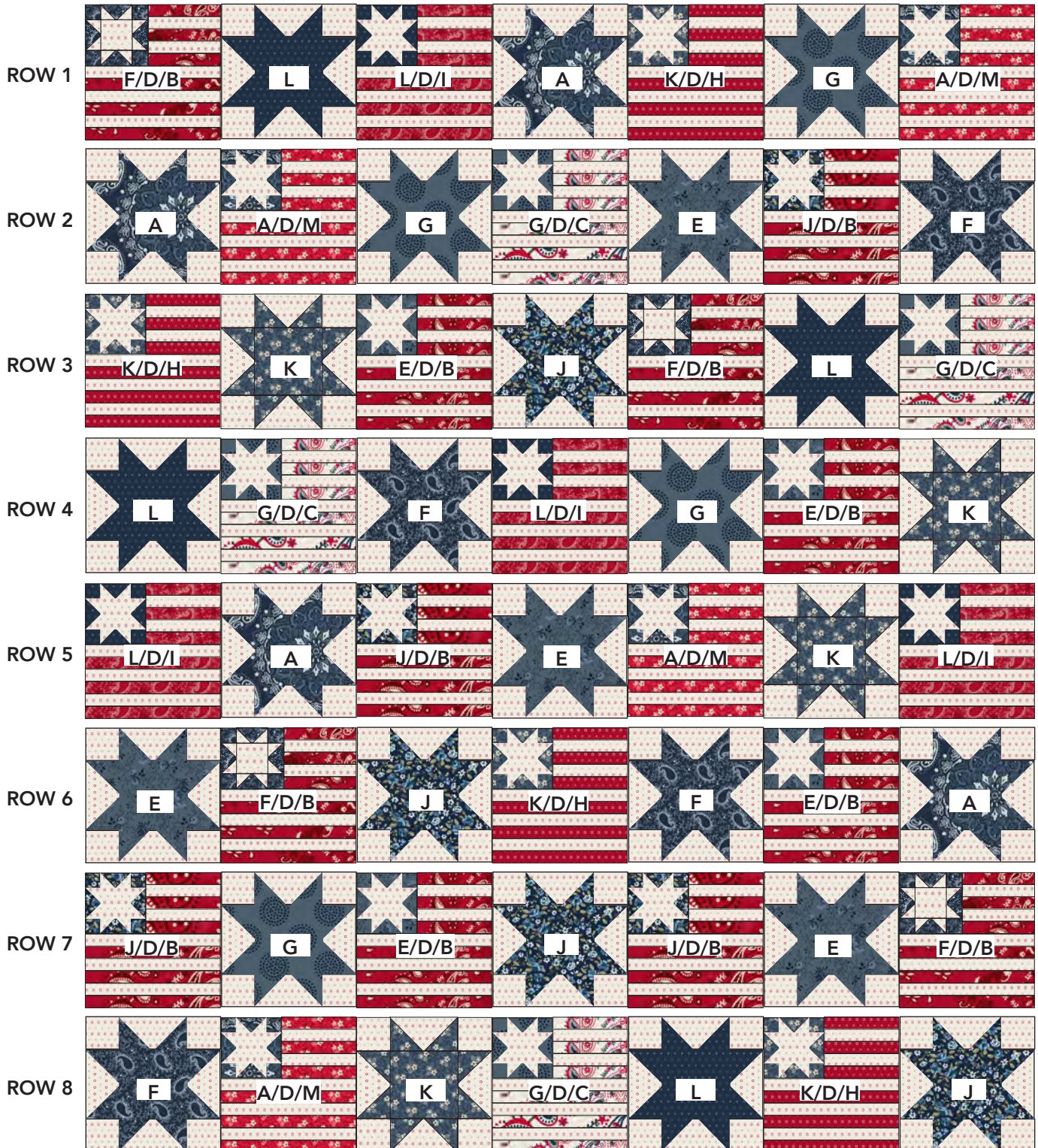

FINISHING: Layer quilt top, batting and backing together to form quilt sandwich. Baste and quilt as desired. Bind using **G** 2-1/2" strips.