

Happy Christmas

Designed by Wendy Sheppard

Featuring Noel by Clare Therese Gray

SIZE: 66" x 72"

INTERMEDIATE
SKILL

FREE
PROJECT



THIS IS A DIGITAL REPRESENTATION OF THE QUILT TOP, FABRIC MAY VARY.

PLEASE NOTE: BEFORE MAKING YOUR PROJECT, CHECK FOR ANY PATTERN UPDATES AT WINDHAMFABRICS.COM'S FREE PROJECTS SECTION.



Happy Christmas

WOF = WIDTH OF FABRIC







KEY	FABRIC	SKU	YD	CUTTING INSTRUCTIONS
A		53045-1 White	1-3/8	Outer Border: (7) 5-1/2" x WOF strips. Piece strips and subcut (2) 5-1/2" x 62-1/2" and (2) 5-1/2" x 66-1/2" strips.
B		53046-1 White	1/8	Snowball Block: (1) 3-1/2" x WOF strip; subcut (4) 3-1/2" squares.
C		53046-3 Pine	1/8	Snowball Block: (1) 3-1/2" x WOF strip; subcut (7) 3-1/2" squares.
D		53047-1 White	1/8	Snowball Block: (1) 3-1/2" x WOF strip; subcut (8) 3-1/2" squares.
E		53047-4 Pink	1/8	Snowball Block: (1) 3-1/2" x WOF strip; subcut (8) 3-1/2" squares.
F		53047-5 Mint	1/8	Snowball Block: (1) 3-1/2" x WOF strip; subcut (9) 3-1/2" squares.
G		53048-1 White	1/8	Snowball Block: (1) 3-1/2" x WOF strip; subcut (8) 3-1/2" squares.
H		53048-2 Aqua	1/2	Big Tree Block: (4) 2-1/2" x WOF strips, subcut (8) 2-1/2" x 4-1/2" and (16) 2-1/2" x 5-1/2" rectangles. Snowball Block: (1) 3-1/2" x WOF strip; subcut (8) 3-1/2" squares.
I		53048-3 Pine	1/8	Snowball Block: (1) 3-1/2" x WOF strip; subcut (8) 3-1/2" squares.
J		53049-1 White INCLUDES BINDING	1-3/8	Binding: (8) 2-1/4" x WOF strips. Inner Border 2: (4) 2" x WOF strips; subcut (2) 2" x 36-1/2" and (2) 2" x 39-1/2" strips. Inner Border 5: (6) 1-1/2" x WOF strips. Piece strips and subcut (2) 1-1/2" x 56-1/2" and (2) 1-1/2" x 60-1/2" strips. Snowball Block: (1) 3-1/2" x WOF strip; subcut (8) 3-1/2" squares.
K		53049-6 Red	1/2	Big Tree Block: (3) 2-1/2" x WOF strips, subcut (6) 2-1/2" x 4-1/2" and (12) 2-1/2" x 5-1/2" rectangles. Snowball Block: (1) 3-1/2" x WOF strip; subcut (2) 3-1/2" squares.

PROJECT DISCLAIMER: Every effort has been made to ensure that all projects are error free. All the information is presented in good faith, however, no warranty can be given nor results guaranteed. Therefore, we assume no responsibility nor damages that may occur when referring to this pattern. When errors are brought to our attention, we make every effort to correct and post a revision as soon as possible. We suggest you check windhamfabrics.com for pattern updates and to test the pattern prior to making the project. Test templates first, before cutting all the pieces. Free projects are not for resale.

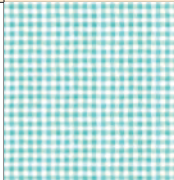

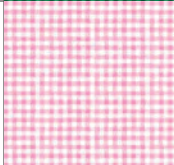
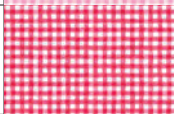
Happy Christmas

WOF = WIDTH OF FABRIC

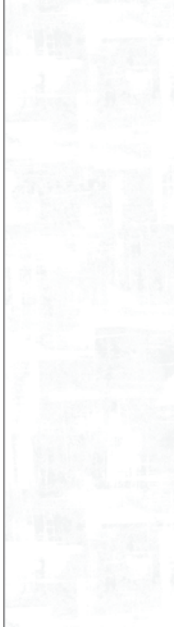
KEY	FABRIC	SKU	YD	CUTTING INSTRUCTIONS
L		53050-2 Aqua	1/4	<p>Snowball Block: (1) 3-1/2" x WOF strip; subcut (6) 3-1/2" squares.</p> <p>Small Tree Block: (1) 2-1/2" x WOF strip; subcut (1) 2-1/2" x 4-1/2" and (1) 2-1/2" x 5-1/2" rectangles.</p>
M		53050-3 Pine	1/8	<p>Snowball Block: (1) 3-1/2" x WOF strip; subcut (8) 3-1/2" squares.</p>
N		53050-4 Pink	1/4	<p>Snowball Block: (1) 3-1/2" x WOF strip; subcut (4) 3-1/2" squares.</p> <p>Small Tree Block: (1) 2-1/2" x WOF strip; subcut (4) 2-1/2" x 4-1/2" and (4) 2-1/2" x 5-1/2" rectangles.</p>
O		53050-6 Red	1/8	<p>Snowball Block: (1) 3-1/2" x WOF strip; subcut (8) 3-1/2" squares.</p>
P		52782-9 Sea Mist	1/8	<p>Snowball Block: (1) 3-1/2" x WOF strip; subcut (10) 3-1/2" squares.</p>
Q		52782-31 Petal	3/8	<p>Snowball Block: (1) 3-1/2" x WOF strip; subcut (6) 3-1/2" squares.</p> <p>Small and Large Tree Blocks: (2) 2-1/2" x WOF strips; subcut (3) 2-1/2" x 4-1/2", (3) 2-1/2" x 5-1/2", (14) 1-1/2" x 2-1/2" rectangles and (12) 1-1/2" squares.</p>
R		52782-32 Summer Pink	1/8	<p>Snowball Block: (1) 3-1/2" x WOF strip; subcut (4) 3-1/2" squares.</p>
S		52782-46 White on White	2-3/4	<p>Inner Border 1: (4) 2" x WOF strips; subcut (2) 2" x 33-1/2" and (2) 2" x 36-1/2" strips.</p> <p>Inner Border 3: (1) 8-1/2" x WOF strip; subcut (4) 8-1/2" squares.</p> <p>Inner Border 4: (6) 1-1/2" x WOF strips. Piece strips and subcut (2) 1-1/2" x 54-1/2" and (2) 1-1/2" x 58-1/2" strips.</p> <p>Snowball Block: (6) 2" x WOF strips; subcut (120) 2" squares.</p> <p>Small Tree Blocks: (5) 2-1/2" x WOF strips; subcut (24) 1" x 2-1/2" and (24) 1-1/2" x 2-1/2" rectangles, and (48) 2-1/2" squares.</p> <p>(1) 3" x WOF strip; subcut (24) 1-1/2" x 3" rectangles.</p> <p>(2) 3-1/2" x WOF strips; subcut (12) 3-1/2" x 6-1/2" rectangles.</p> <p>Big Tree Blocks: (11) 2-1/2" x WOF strips; subcut (56) 1" x 2-1/2", (28) 1-1/2" x 2-1/2" and (28) 2-1/2" x 3" rectangles and (84) 2-1/2" squares.</p>



Happy Christmas

WOF = WIDTH OF FABRIC

KEY	FABRIC	SKU	YD	CUTTING INSTRUCTIONS
T		52782-47 Quartz	1/4	Snowball Blocks: (1) 3-1/2" x WOF strip; subcut (4) 3-1/2" squares. Small Tree Blocks: (1) 2-1/2" x WOF strip; subcut (4) 2-1/2" x 4-1/2" and (4) 2-1/2" x 5-1/2" rectangles.
		Backing	4-1/2	72" x 78" piece of batting.

SNOWBALL BLOCKS

- Four-Patch Unit:** Sew together (1) 3-1/2" square of each **B**, **I**, **O** and **P**, as shown.
- Corner Triangles:** Draw a diagonal line on the wrong side of (1) **S** 2" square. Place square, right sides together (RST), at a corner of the **Four-Patch Unit** made in **step 1**. Sew on drawn line. Trim 1/4" away from sewn line. Open and press to reveal **S** corner triangle. Repeat with (3) additional **S** squares for the remaining corners of the same **Four-Patch Unit** to complete (1) **Snowball Block**. Make (4). Block measures 6-1/2" square unfinished.

Step 1



Step 2



Draw diagonal line on wrong side of **S** square.



Sew on drawn line.



Trim 1/4" and open to reveal **S** corner triangle.

Make (4) of **OPBI**



Repeat on remaining corners.

- Repeat to make a total number of Snowball Blocks in the following colorways:

Make (5) of **MEFJ**



Make (4) of **CDT**

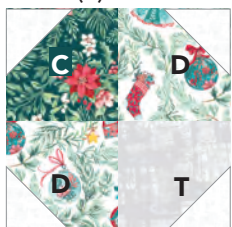

Make (4) of **GLIH**



Make (4) of **QFPN**



Make (4) of **ROGH**



Make (3) of **JCEM**



Make (2) of **PQLK**



SNOWBALL BLOCKS MEASURE 6-1/2" SQUARE UNFINISHED.



Happy Christmas

SMALL TREE BLOCKS

FLYING GEESE UNITS

4. **Unit 1:** Draw a diagonal line on the wrong side of (1) **S** 2-1/2" square. Place square, RST, at a corner of (1) **Q** 2-1/2" x 4-1/2" rectangle. Sew on drawn line. Trim 1/4" away from sewn line. Open and press to reveal **S** corner triangle. Repeat with another **S** square at the opposite corner of the same **Q** rectangle to complete **Flying Geese** piece.

5. Sew (2) **S** 1-1/2" x 2-1/2" rectangles to the short sides of **Flying Geese** piece to make **Unit 1**.

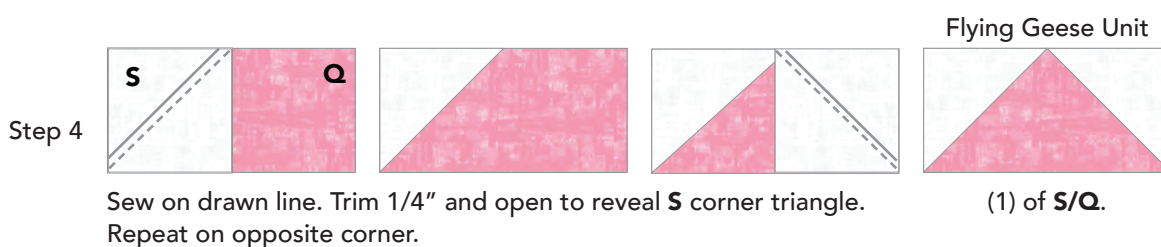

6. **Unit 2:** Repeat step 4 (**Flying Geese**) using (2) **S** 2-1/2" squares and (1) **Q** 2-1/2" x 5-1/2" rectangle. For step 5 use (2) **S** 1" x 2-1/2" to complete **Unit 2**.

7. **Unit 3:** Sew (2) **S** 1-1/2" x 3" rectangles to the opposite sides of (1) **Q** 1-1/2" square.

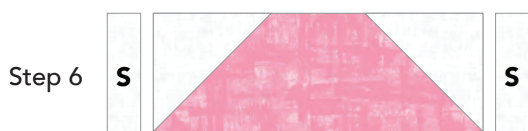

8. Sew **Units 1-3** together, as shown, then add (1) **S** 3-1/2" x 6-1/2" rectangle to the top of sewn unit to complete (1) **Small Tree Block**, measuring 6-1/2" x 8-1/2" unfinished. Make (3).

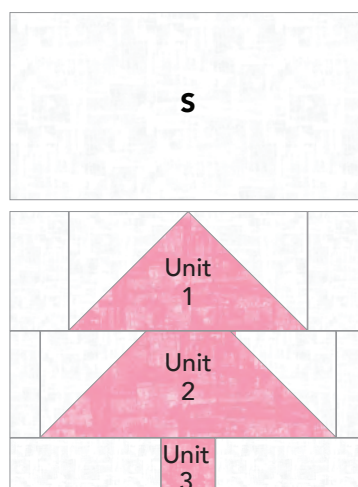

Small Tree Block
Make (3) of **Q**
Measures: 6-1/2" x 8-1/2"



Happy Christmas

9. Using **S** fabric, repeat **Steps 4-8** to make a total number of **Small Tree Blocks** in the following colorways:

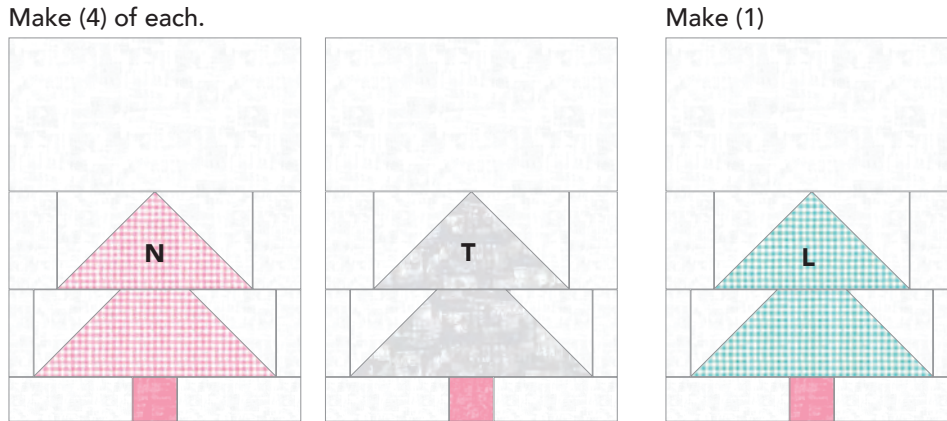

BIG TREE BLOCKS

10. Repeat **Steps 4-7** to assemble the **Big Tree Blocks**.

Unit 1: Use (2) **S** 2-1/2" squares and (1) **H** 2-1/2" x 4-1/2" rectangle (flying geese piece). Then add (2) **S** 1-1/2" x 2-1/2" rectangles to the short sides to complete Unit 1.

Unit 2: Use (2) **S** 2-1/2" squares and (1) **H** 2-1/2" x 5-1/2" rectangle (flying geese piece). Then add (2) **S** 1" x 2-1/2" rectangles to the short sides to complete Unit 2. Make (2).

Unit 3: Use (2) **S** 2-1/2" x 3" rectangles and (1) **Q** 1-1/2" x 2-1/2" rectangle.

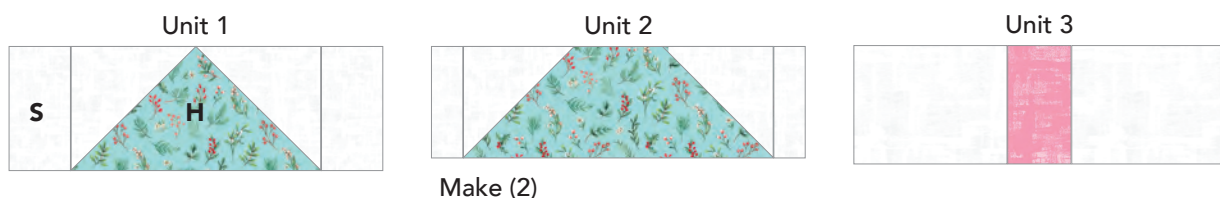

11. Sew **Units 1-3** together, as shown to complete (1) **Big Tree Block**, measuring 6-1/2" x 8-1/2" unfinished. Make (8).

12. Repeat **Steps 10 and 11** to make (6) of **K**.

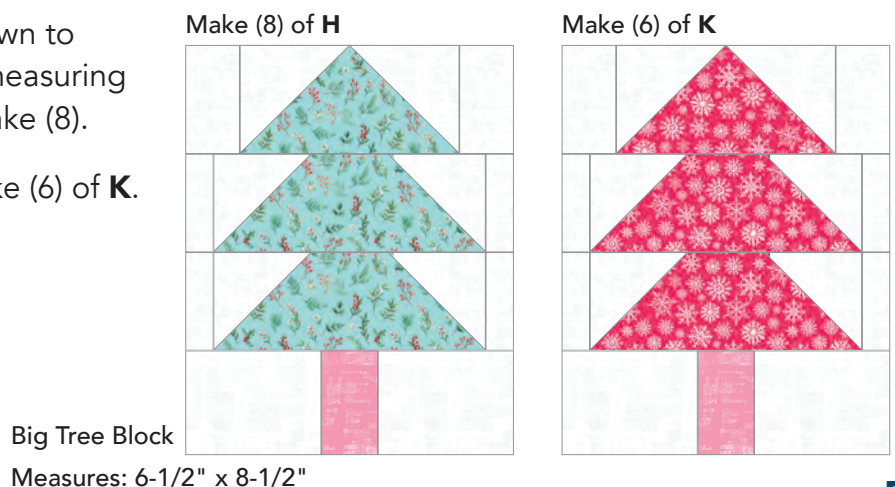



Happy Christmas

QUILT ASSEMBLY

REFER TO QUILT IMAGE FOR BLOCK PLACEMENT GUIDE ON PAGE 7.

13. **Pieced Rows:** Arrange and sew (5) **Snowball Blocks** into a row. Make (6) rows. Row 1 is shown below.



14. Arrange and sew together **Pieced Rows** to complete quilt center.
15. **Inner Border 1:** Sew (2) **S** 2" x 36-1/2" strips to the opposite long sides of quilt center. Sew (2) **S** 2" x 33-1/2" strips to the remaining opposite short sides of quilt center.
16. **Inner Border 2:** Sew (2) **J** 2" x 39-1/2" strips to the opposite long sides of quilt center. Sew (2) **J** 2" x 36-1/2" strips to the remaining opposite short sides of quilt center.
17. **Inner Border 3:**
- Columns:** Arrange and sew together (7) **Tree Blocks** into columns. Make (2). Add columns to the left and right sides of quilt center, respectively.
 - Rows:** Arrange and sew (6) **Tree Blocks** and (2) **S** 8-1/2" squares into rows. Make (2). Add rows to the top and bottom of quilt center, respectively.
18. **Inner Border 4:** Sew (2) **S** 1-1/2" x 58-1/2" strips to the opposite long sides of quilt center. Sew (2) **S** 1-1/2" x 54-1/2" strips to the remaining opposite short sides of quilt center.
19. **Inner Border 5:** Sew (2) **J** 1-1/2" x 60-1/2" strips to the opposite long sides of quilt center. Sew (2) **J** 1-1/2" x 56-1/2" strips to the remaining opposite short sides of quilt center.
20. **Outer Border:** Sew (2) **A** 5-1/2" x 62-1/2" strips to the opposite long sides of quilt center. Sew (2) **A** 5-1/2" x 66-1/2" strips to the remaining opposite short sides of quilt center.



Happy Christmas

QUILT ASSEMBLY

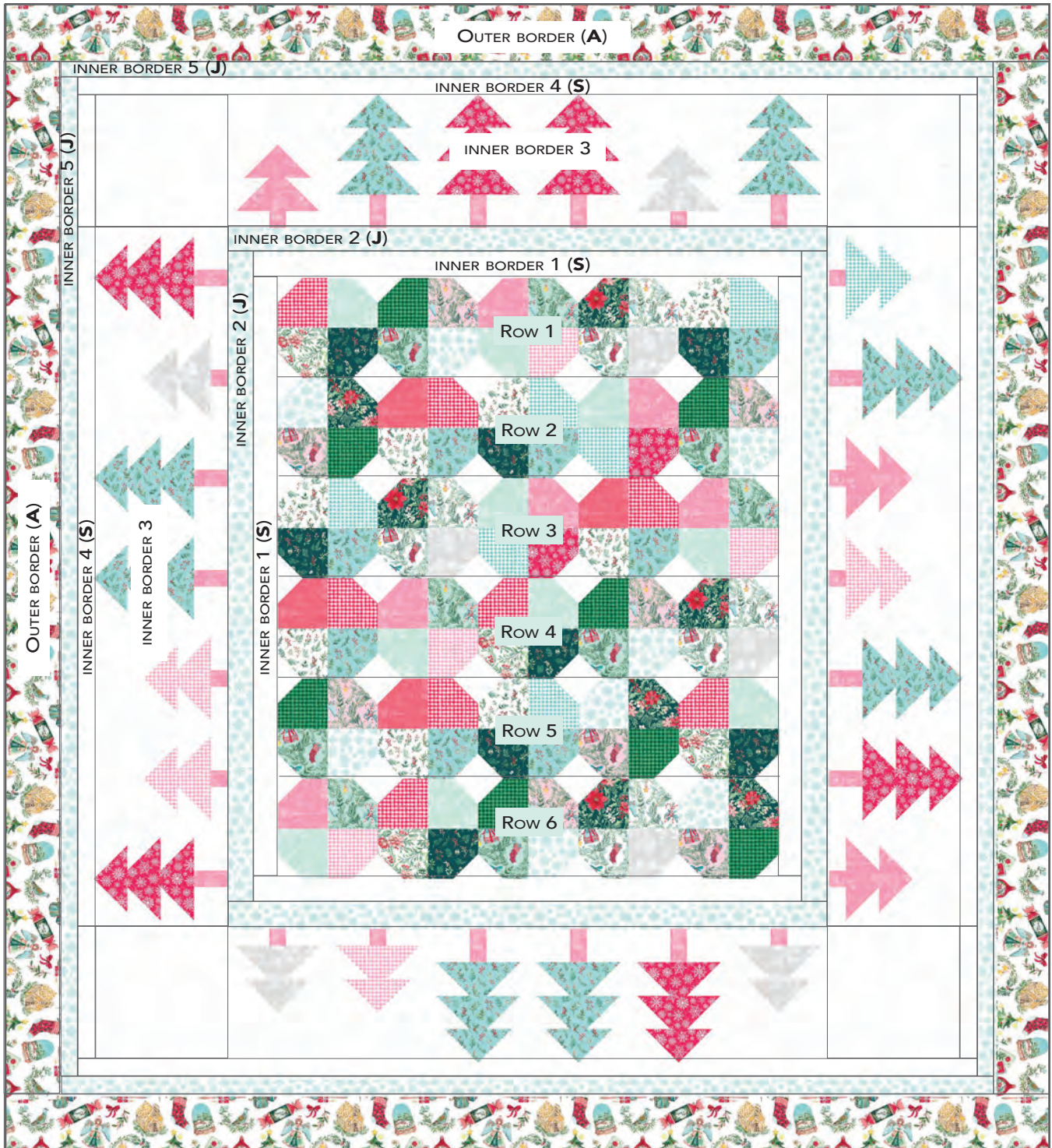

FINISHING: Layer quilt top, batting and backing together to form quilt sandwich. Baste and quilt as desired. Bind using **J** 2-1/4" strips.