

INTERMEDIATE
SKILL

Floral Fantasy

designed by Marsha Evans Moore
featuring *Impressions* by Melissa Marie Collins

APPLIQUÉ TECHNIQUE REQUIRED

SIZE: 60" x 82"



THIS IS A DIGITAL REPRESENTATION OF THE QUILT TOP, FABRIC MAY VARY.

PLEASE NOTE: BEFORE MAKING YOUR PROJECT, CHECK FOR ANY PATTERN UPDATES AT WINDHAMFABRICS.COM'S FREE PROJECTS SECTION.









FREE
PROJECT

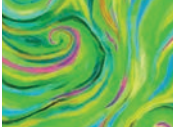

Floral Fantasy

NOTE: Please read the entire pattern before you begin. For turned under appliqué techniques, trace templates and cut along the solid outer line. For raw edge appliqué techniques, trace templates and cut along the inner solid line. The templates and placement patterns are found on pages 8-10. See appliqué instruction before cutting templates. Reverse Fabric N triangles on WOF strips to conserve fabric.

WOF = WIDTH OF FABRIC

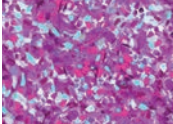

KEY	FABRIC	SKU	YD	CUTTING INSTRUCTIONS
A		53015D-3 Neutral	3/8	(4) 2-1/2" x WOF strips; subcut (10) 2-1/2" x 11-1/4" strips.
B		53016D-1 Purple	7/8	(7) 2-1/2" x WOF strips, sew short ends together. Subcut (2) 2-1/2" x 78-1/2" and (2) 2-1/2" x 56-1/2" borders. (24) Diamond templates.
C		53016D-4 Green	3/4	(16) Large Leaf templates. (8) Small Leaf templates.
D		53016D-5 Teal	3/8	(16) Medium Leaf templates.
E		53016D-6 Yellow	2/3	(8) Diamond templates. (20) Petal templates.
F		53016D-7 Grey	3/8	(4) 2-1/2" x WOF strips; subcut (10) 2-1/2" x 11-1/4" strips.
G		53016D-8 Cream	1-1/8	(4) 8-1/2" x WOF strips; subcut (16) 8-1/2" squares.
H		53016D-10 Fire	2/3	(12) Diamond templates. (24) Petal templates. (4) 2-1/2" squares.
I		53017D-1 Purple	5/8	(12) Diamond templates. (24) Petal templates.

PROJECT DISCLAIMER: Every effort has been made to ensure that all projects are error free. All the information is presented in good faith, however, no warranty can be given nor results guaranteed. Therefore, we assume no responsibility nor damages that may occur when referring to this pattern. When errors are brought to our attention, we make every effort to correct and post a revision as soon as possible. We suggest you check WINDHAMFABRICS.COM for pattern updates and to test the pattern prior to making the project. **TEST TEMPLATES FIRST, BEFORE CUTTING ALL THE PIECES.** Free projects are not for resale.

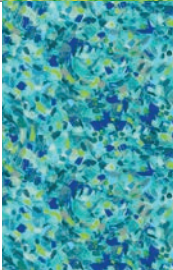
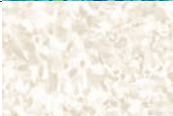
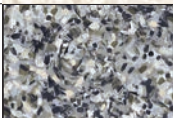
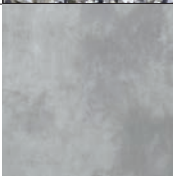

Floral Fantasy

WOF = WIDTH OF FABRIC

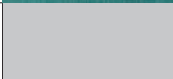
KEY	FABRIC	SKU	YD	CUTTING INSTRUCTIONS
J		53017D-4 Green	3/8	(16) Diamond templates.
K		53017D-5 Teal	1	(6) 2-1/2" x WOF strips, sew short ends together. Subcut (2) 2-1/2" x 64-1/2" and (2) 2-1/2" x 42-1/2" borders and (4) 2-1/2" squares. (12) Petal templates. (8) Diamond templates.
L		53017D-8 Cream	1-1/8	(4) 8-1/2" x WOF strips; subcut (16) 8-1/2" squares.
M		53017D-7 Grey	3/8	(4) 2-1/2" x WOF strips; subcut (10) 2-1/2" x 11-1/4" strips.
N		37098-2 Ash	3/4	(7) 4-1/2" x WOF strips; subcut (32) Large Triangle templates. (2) 4" x WOF strips; subcut (8) Small Triangle templates and (8) Small Triangle templates reversed.
O		37098-68 Dragon Scale BINDING INCLUDED	1-1/4	FOR RAW EDGE APPLIQUÉ: (7) Stems templates and (7) Stems reversed. (1) Short Stem and (1) Short Stem reversed. FOR TURNED EDGE APPLIQUÉ: (14) 1-1/4" x 13" bias strips. (2) 1-1/4" x 10-1/2" bias strips. BINDING: (8) 2-1/4" x WOF" strips, sew short ends together. (4) 5-1/2" squares. (16) Quarter Circle templates.
		Backing	5	68" x 90" batting.

ADDITIONAL MATERIALS

Thread to match fabrics
Basic sewing supplies

Sewing machine
Template plastic

Water soluble fabric marker
Rotary cutter, ruler and mat

Optional: For turned under edge appliqué: freezer paper or other template paper.
For raw edge appliqué: paper backed fusible webbing.



Floral Fantasy

BLOCKS

1. Using your favorite appliqué method, prepare Large, Medium and Small Leaf appliqué pieces. Prepare raw edge appliqué Stems in the same way as leaves.
2. For turned edge appliqué stems, fold (14) **O** 13" and (2) 10-1/2" bias strips in half lengthwise with wrong sides together. Sew 1/4" from fold. Trim raw edge 1/8" from stitching. Press stem flat with seam centered on one side. Make the number indicated.

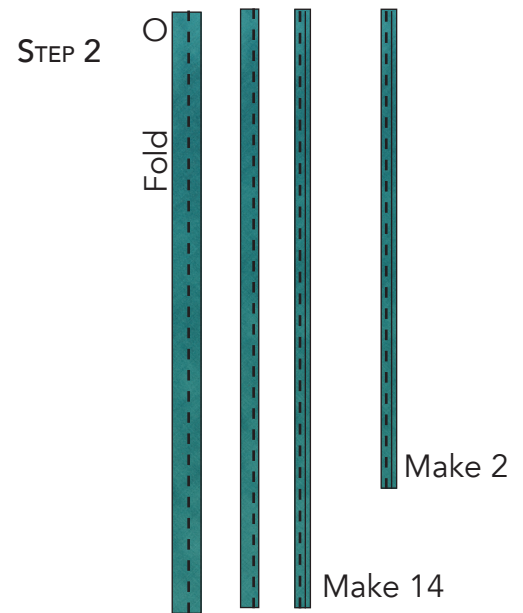

3. Sew (1) **E** petal to (1) **K** petal along 1 long edge. For turned under appliqué, begin stitching at corner of seamline.
4. Sew (2) **K** petals and (1) **E** petal in the same manner alternating the fabrics to complete **K/E** petal unit. Make 1.
5. Align the center of the inner curve of (1) **K/E** petal unit and the curved edge of (1) **O** quarter circle and then pin the centers together. Pin the ends together. Ease the curves along the seamline and pin about every 1/2". Clip seam allowance if necessary.
6. Carefully and slowly, sew along the seamline. Press the seam toward the quarter circle to complete the flower unit. For turned under appliqué, press under the seam allowance on the short outer edges of the petals.

STEP 3

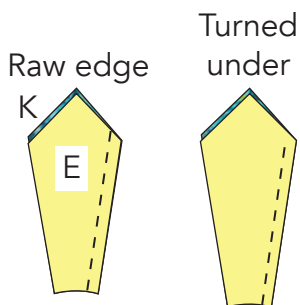

STEP 4

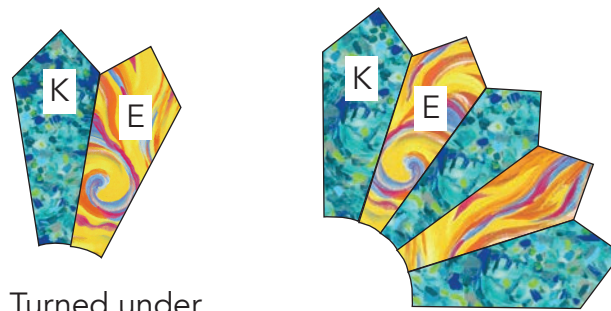

STEP 5

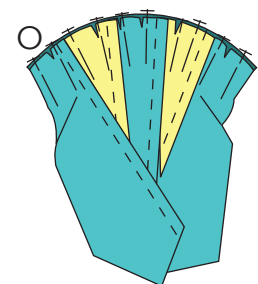

STEP 6

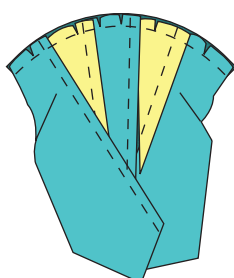

Turned under

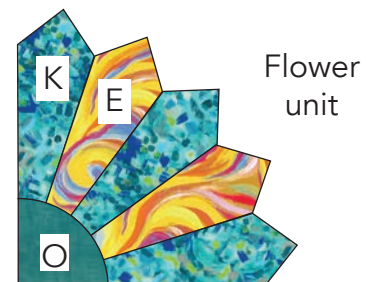
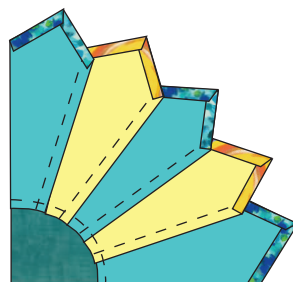



Floral Fantasy

7. Sew (1) **G** 8-1/2" square to (1) **L** 8-1/2" square along 1 edge. Pin flower unit to corner of L square. Trace stem placement to **G/L** rectangle unit.
Trace stem placement to **G/L** rectangle unit.
8. Pin, fuse or baste stem to **G/L** rectangle unit tucking the end under outer edge of flower unit. Sew stem and outer edge of flower unit in place along edges. Baste flower unit to rectangle along side and lower seamline.
9. Pin, fuse or baste (1) **C** Large Leaf applique and (1) **D** Medium Leaf to position on **G/L** rectangle unit. Sew leaves in place along edges to complete block. Make 2.
10. Following steps 3-9, make blocks using **E** and **I** petal combination and **H** and **I** petal combination as shown. Make the number indicated.

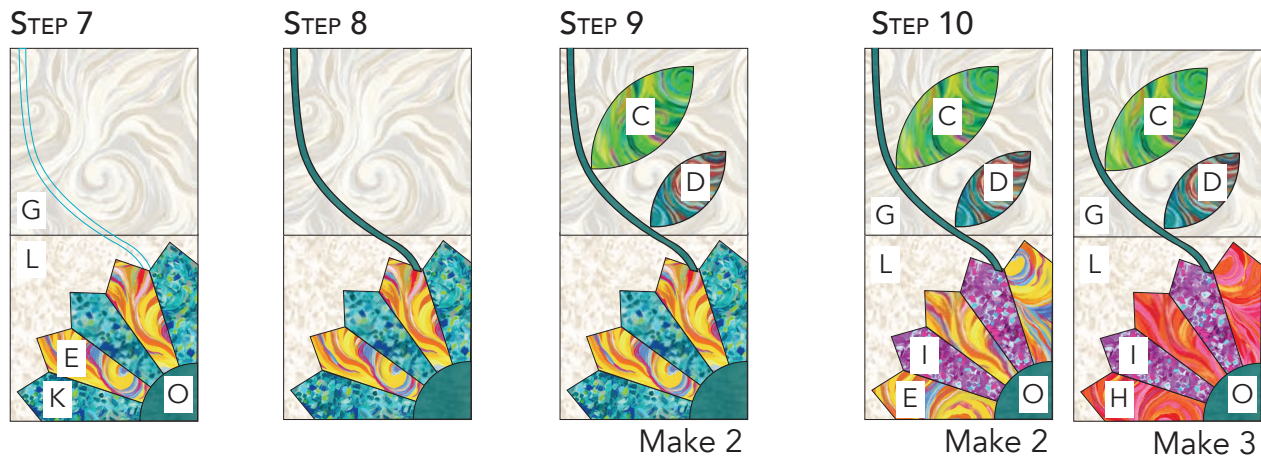

11. Following steps 3-10, make mirror image blocks using the reversed stems. Make the number indicated.
12. Make 2 flower blocks using **H** and **I** Petals. Make 2 leaf blocks using short stems. Make 1 each.

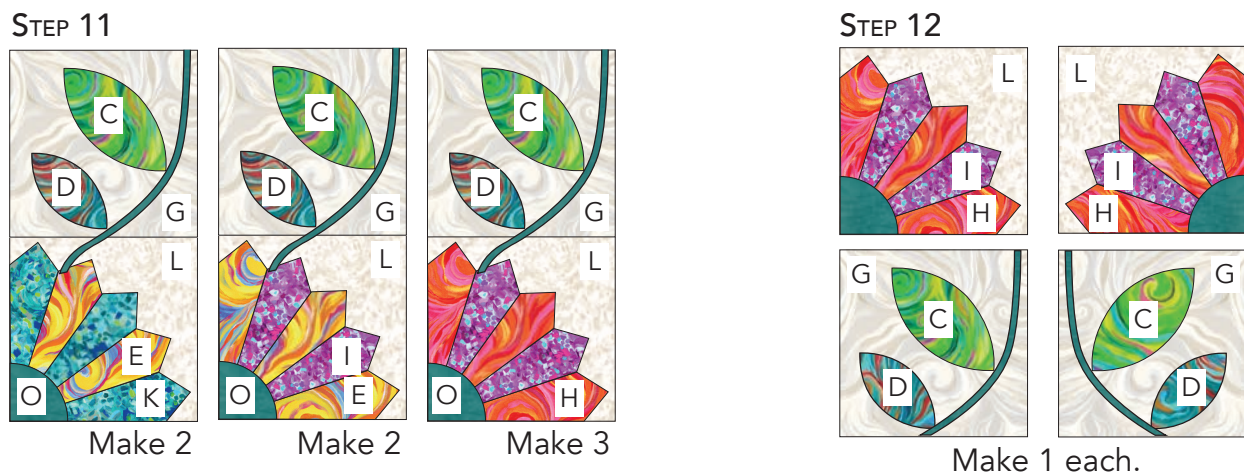



Floral Fantasy

PATCHWORK BORDERS

- 13. Sew (1) **B** Diamond to (1) **J** Diamond to make a diamond pair. Make 2.
- 14. Sew (2) **B/J** diamond pairs together matching the seams to make a diamond unit. Make 6.
- 15. In the same manner, make the following diamond units: **E/B**, **E/J**, **H/I** and **B/K**. Make the number indicated.

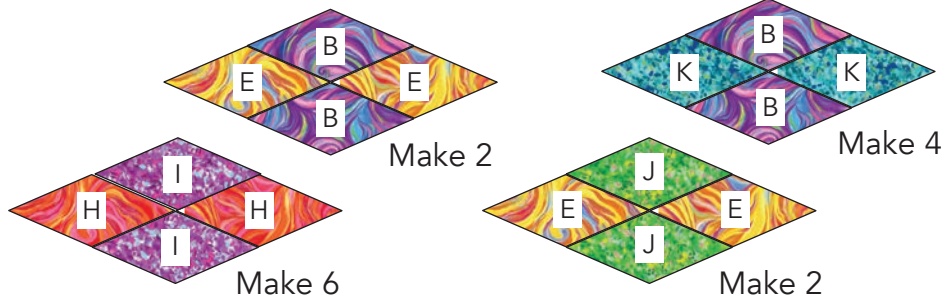
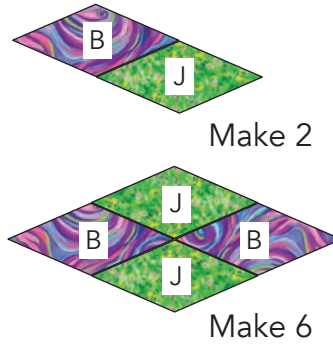

- 16. Sew (1) **N** Small Triangle and (1) Large Triangle to opposite sides of (1) **E/J** diamond unit to make an end unit. Make 1. Repeat with (1) **B/K** diamond unit. Make 1.
- 17. Sew (2) **N** Large Triangles to opposite sides of (1) **H/I** diamond unit to make a diamond/triangle unit. Make 1. Repeat with (1) **B/J** diamond unit. Make 1.
- 18. Sew the end units and diamond/triangle units together. Sew (1) **N** Small Triangle reversed to each corner to make top and bottom patchwork borders. Borders should measure about 45-1/2" x 5-1/2". Make 2.

Top and Bottom Patchwork Borders

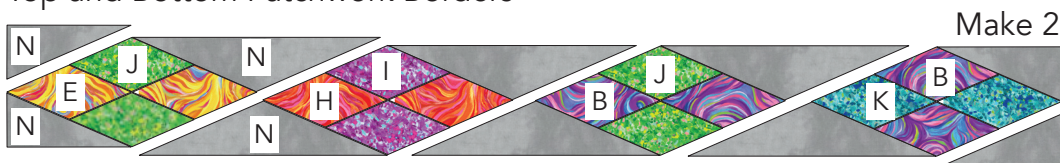

- 19. Sew (1) **N** Small Triangle and (1) Large Triangle to opposite sides of (1) **B/J** diamond unit to make an end unit. Make 4.
- 20. Following step 17, make (4) **H/I**, (2) **B/E**, and (2) **B/K** diamond/triangle units.
- 21. Sew the end units and diamond/triangle units together. Sew (1) **N** Small Triangle reversed to each corner to make side patchwork borders. Borders should measure about 68" x 5-1/2". Make 1 each.

SIDE PATCHWORK BORDERS

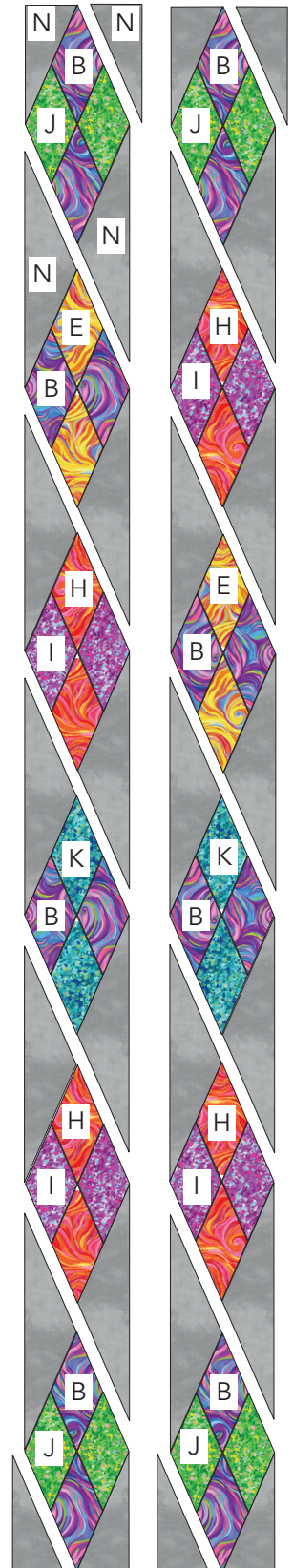



Floral Fantasy

CORNER BLOCKS

22. Pin, fuse or baste (2) **C** Small Leaf appliqués to **O** 5-1/2" squares. Leaves should be 1/2" from edge of square. Sew leaves in place along edges to complete corner block. Make 4.

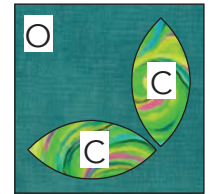

Make 4

QUILT CENTER ASSEMBLY

23. Following the layout diagram on page 7, arrange the rectangular blocks and square blocks in 4 rows. Note the color of the flowers and the orientation of blocks. Sew the blocks in each row together to make the block rows.
24. Sew the short ends of (2) **A** 2-1/2" x 11-1/4" strips, (2) **F** 2-1/2" x 11-1/4" strips and (2) **M** 2-1/2" x 11-1/4" strips together to make the sashing rows. Note the position of the fabric strips in each row. Trim sashing rows to 64-1/2" long. Make 5.
25. Sew together (5) sashing rows alternating with (4) block rows to make the quilt center.

BORDERS

26. Sew (1) **K** 2-1/2" x 64-1/2" border to each side of quilt center. Sew (2) **H** 2-1/2" squares to ends of (2) **K** 2-1/2" x 42-1/2" borders. Sew to top and bottom of quilt.
27. Find and mark center of quilt and side Patchwork Borders. Match center points and pin and stitch borders to quilt center, easing to fit if needed. Note position of diamonds. Sew (2) corner blocks to ends of (2) top and bottom borders. Note position of leaves on blocks. Sew to top and bottom of quilt in the same manner.
28. Sew (1) **B** 2-1/2" x 78-1/2" border to each side of quilt center. Sew (2) **K** 2-1/2" squares to ends of (2) **B** 2-1/2" x 56-1/2" borders. Sew to top and bottom of quilt.

FINISHING

Layer quilt top, batting and backing together to form quilt sandwich. Baste and quilt as desired. Bind using **O** 2-1/4" strips.



Quilt Layout

Floral Fantasy





Floral Fantasy

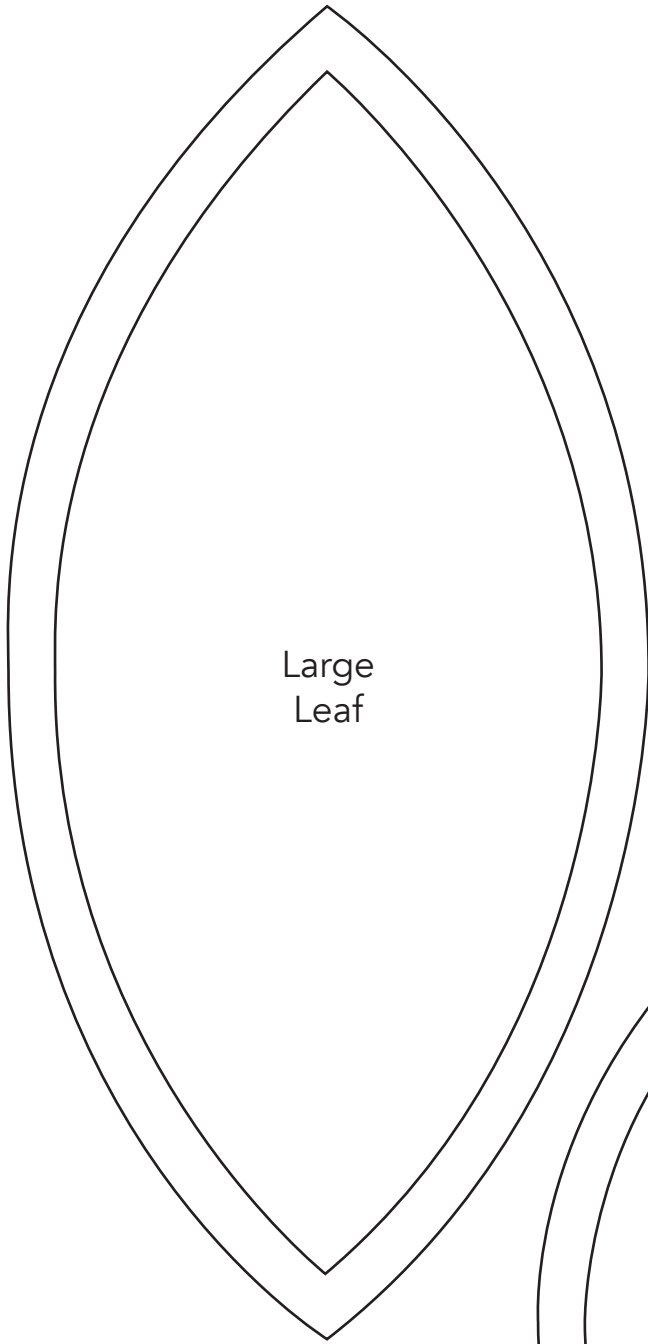

Large
Leaf

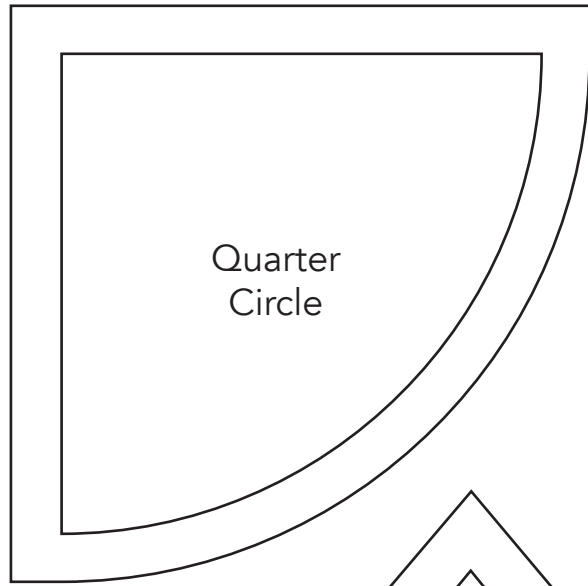

Quarter
Circle

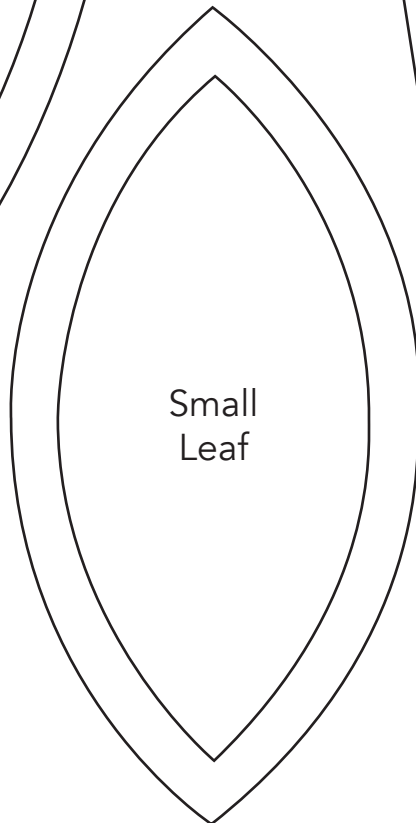

Small
Leaf

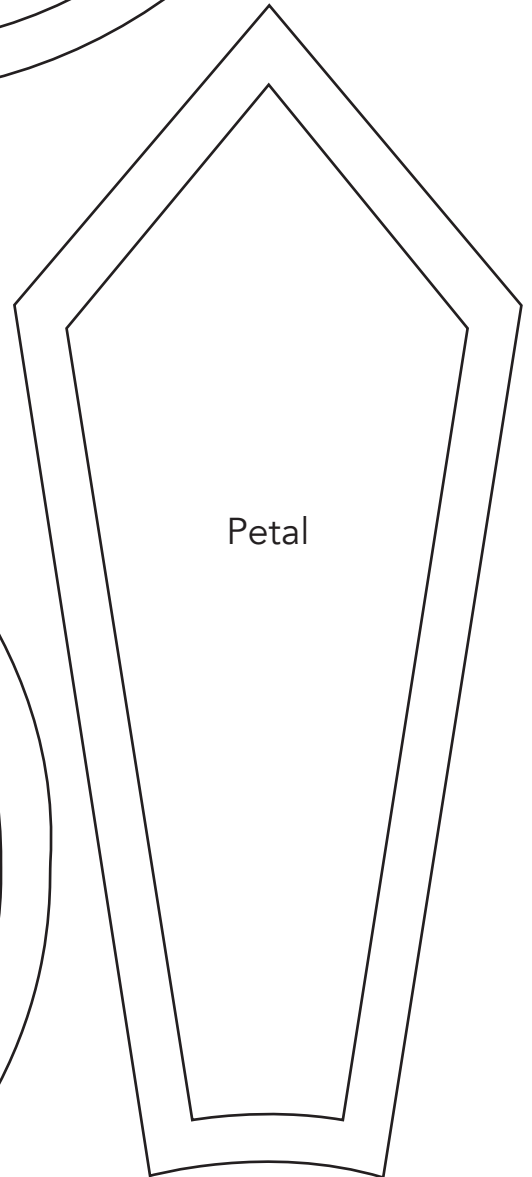

Petal

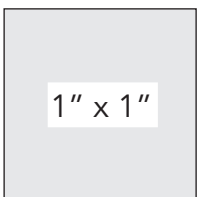

1" x 1"

Print at 100%.



Floral Fantasy

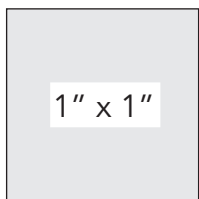
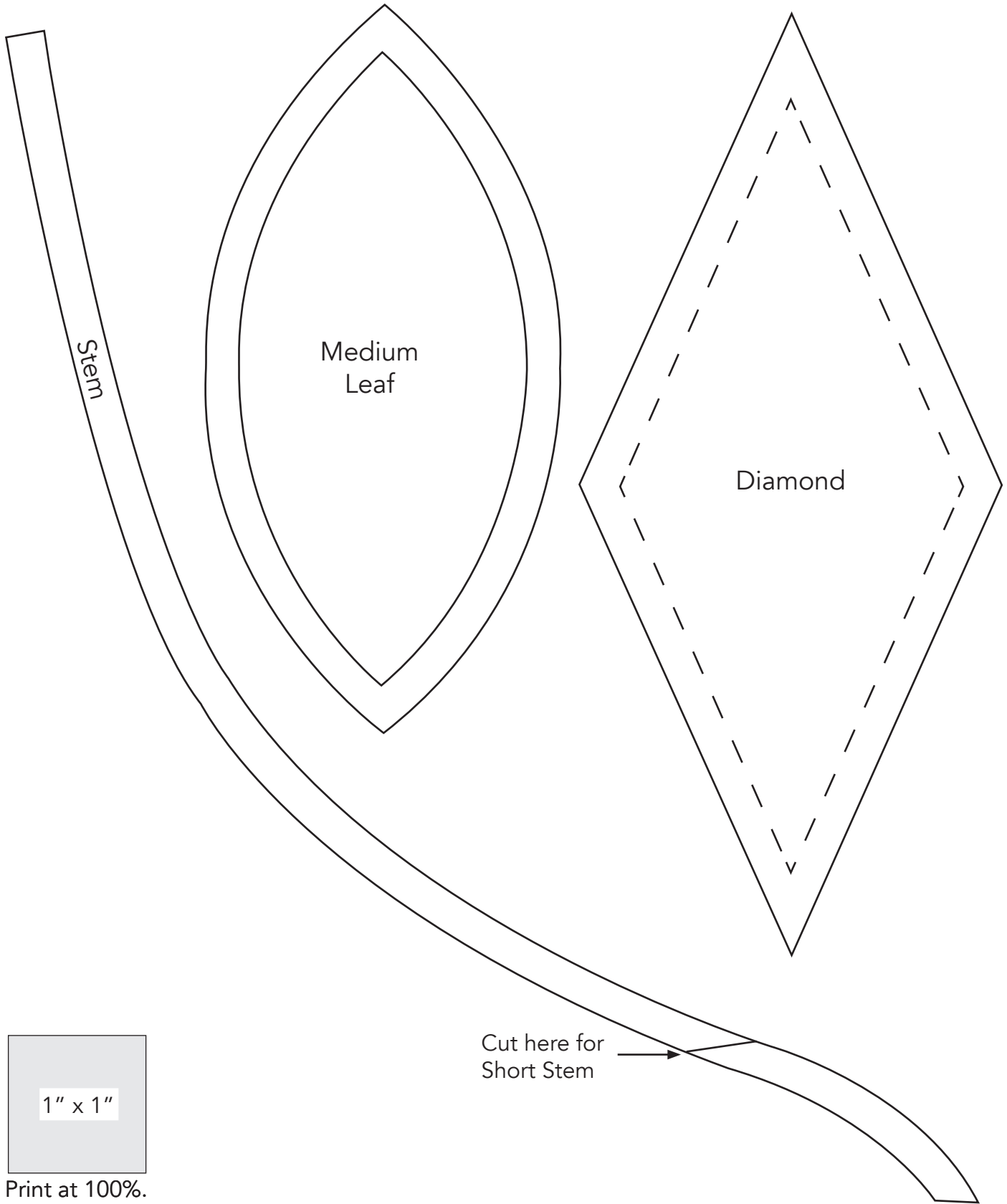

1" x 1"

Print at 100%.



Templates

Floral Fantasy

Cut out Large Triangle templates. Place the right template over the gray area of the left template matching the center lines. Tape or glue together.

