

# Lafayette Star Quilt

Designed and sewn by Debby Kratovil  
Longarm quilted by Kathryn Gray

## Making the sashing units

- Cut 48 squares 4-1/4" x 4-1/4" of the 28480-8 Black fabric. Also cut 192 squares 2-3/8" x 2-3/8" of the 28478-3 Blue.
- Place a light 2-3/8" square in each corner of the dark 4-1/4" square and sew along the diagonal as shown. Trim away waste triangle and press out. After each corner is sewn, you have a square in a square unit. Make 48 of these.
- Join 4 square in a square units together to form a sashing unit. Make 12 of these units.
- Cut 9 squares 4-1/4" x 4-1/4" of the 28480-8 Black fabric. Join these with the 12 sashing units and the 4 Lafayette Star blocks to form the quilt center.

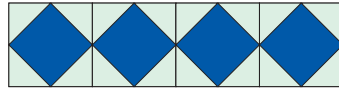

Sashing Units - Make 12 rows

## Borders

- Cut 4 strips 4-1/4" x 27" of the 28481-1 Red, 12 squares 4-1/4" of 28479-3 Blue/Red, and 8 squares 4-1/4" of 28478-3 Blue. Refer to quilt picture for assembly.

## Finishing the Quilt

- Cut 5 strips 2-1/4" x wof from the 28481-1 Red for binding. Sew into long strip.
- Layer quilt top, batting and backing; quilt as desired. Sew binding to quilt to finish.

### Helena by Nancy Gere

*Nancy Gere continues to make us ask, "what will she come up with next?" The answer is Helena! Inspired by early 20th century European designs, Helena offers a unique blend of the simple and the complex in a pleasing, easy to work with color pallet.*

*Nancy admits that the swatches which eventually became Helena had been sitting in her studio "collecting dust." Finally, the broad tulip pattern was introduced in the gold and blue combination, which made the group come to life.*

Be sure to visit [www.windhamfabrics.com](http://www.windhamfabrics.com) to see the complete collection and to download this and other Free Projects.

 Windham Fabrics

812 Jersey Ave • Jersey City, NJ 07310 • 201.659.0444 • FAX: 201.659.9719 • [info@windhamfabrics.com](mailto:info@windhamfabrics.com)

P R O J E C T

# Lafayette Star Quilt

Designed and sewn by Debby Kratovil  
Longarm quilted by Kathryn Gray



Created with fabrics from the  
Helena collection by Nancy Gere

 Windham Fabrics

# Lafayette Star Quilt

Designed and sewn by Debby Kratovil  
 Longarm quilted by Kathryn Gray  
 Block Size: 15"  
 Quilt Size: 50" x 50"

**Fabrics:** All fabrics are from the Helena collection by Nancy Gere for Windham Fabrics.

1/4 yard each of the following for the blades:

- 28480-3 Blue
- 28484-1 Red
- 28477-1 Red
- 28486-3 Blue

1/2 yard each of the following:

- 28483-6 Cream/Red
- 28481-6 Cream/Red
- 28483-1 Red

5/8 yard 28479-3 Blue/Red

3/4 yard 28480-8 Black

1 yard 28478-3 Blue

1 yard 28481-1 Red (border and binding)

2 yards light weight interfacing (NOT fusible)

## Making the Star blocks

- Transfer template markings to template material or freezer paper and cut out.
- Cut one 7-1/4" strip x wof EACH of: 28480-3 Blue; 28484-1 Red; 28477-1 Red; 28486-3 Blue. Cut out 8 blades from each of the four fabrics (see Diagram 1).

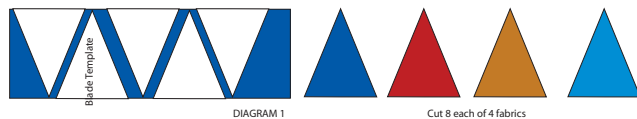

- Fold each blade fabric piece in half along the length, right sides together. Sew a 1/4" seam across the straight edge as shown in Diagram 2. Trim away small triangle of fabric at corner of seam to ensure a sharp point when turned.

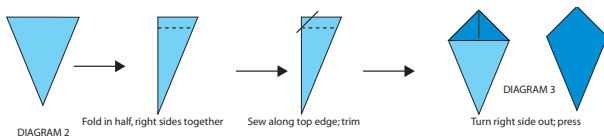

- Turn the unit right side out and press the "pocket" down as shown. This has naturally turned under the top edges to form the outside angle (Diagram 3).
- Sew 4 matching blades with a companion set of 4 matching blades, pressing the seams open on the back. Make two blocks using one combination of colors and two blocks using another (Diagram 4).
- Cut out two 14-1/2" squares each of the background fabrics (28483-6 Cream/Red and 28481-6 Cream/Red). Pair the Stars with coordinating background squares and appliqué the stars, taking care to center them on the background squares. Trim away the background fabric from behind the stars to reduce bulk (Diagram 5).

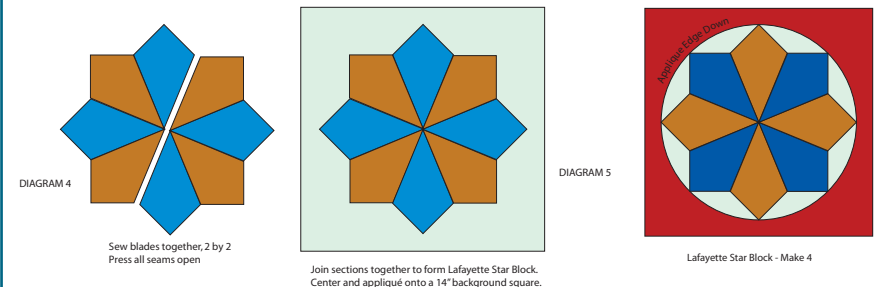

## Adding the outside backgrounds

- Cut out two 15-1/2" squares EACH of 28483-1 Red and 28479-3 Blue/Red.
- On a 15-1/2" square of freezer paper, transfer the template markings of the background template. You will need to fold the freezer paper in quarters. Cut out the center circle (do not remove the seam allowance).
- Iron the freezer paper to the right side of a 15-1/2" square and cut out the center circle/donut hole.
- Using a 15-1/2" square of interfacing, sew around the center donut hole with a 1/4" seam. Trim away the interfacing, clipping the curved edges to allow for a smooth edge when turned under. Repeat for each of the 3 remaining 15-1/2" squares.
- Place the newly formed squares with center holes over each of the 4 Lafayette Star blocks, centering the blades as needed. Reverse appliqué these units in place.
- Finally trim away the remaining light colored background fabric from behind.

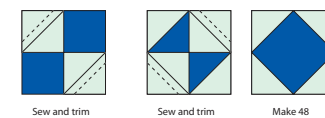

**Templates for Lafayette Star quilt**

Shown at 100%

Designed by Debby Kratovil  
Quilted by Kathryn Gray

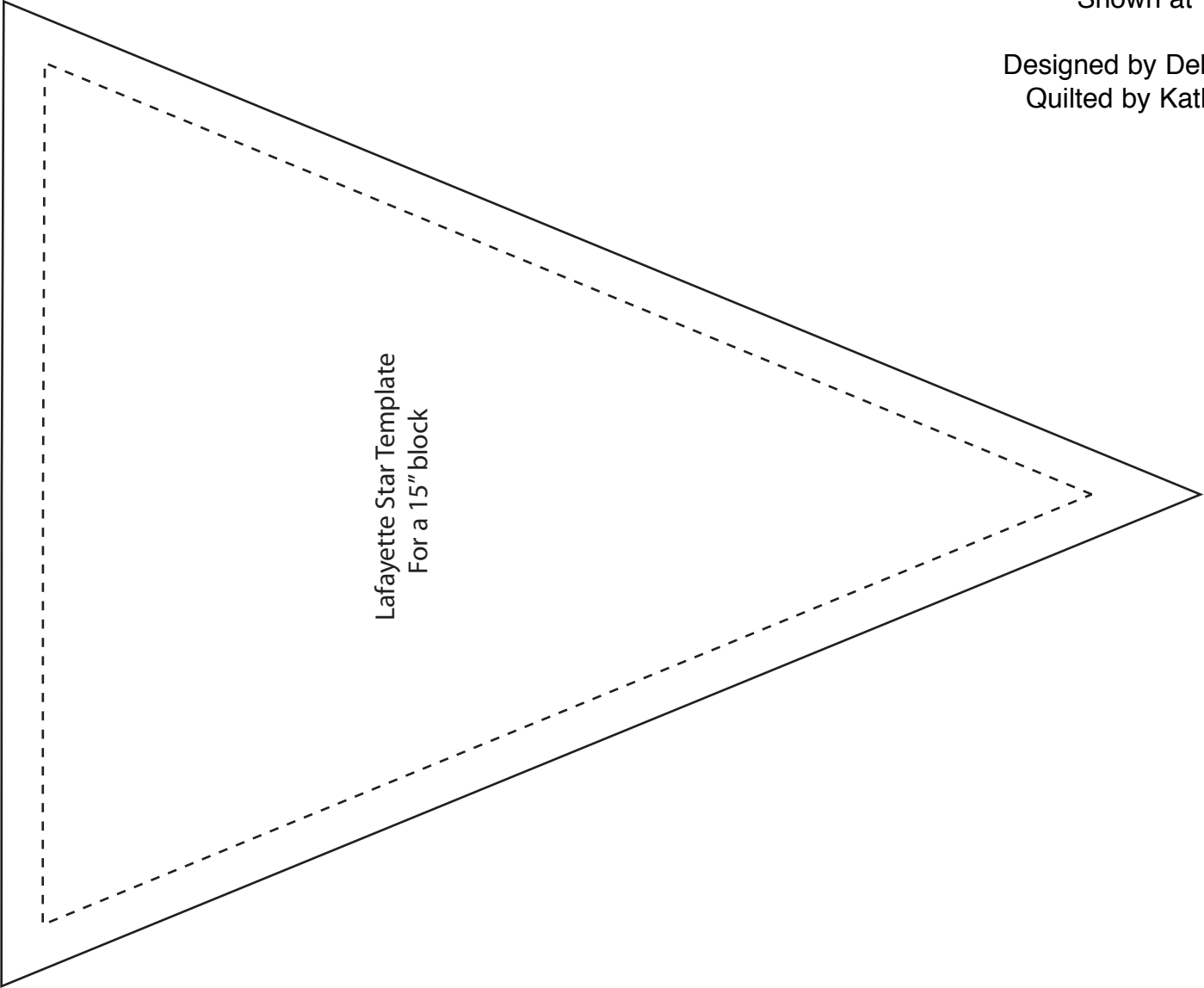

Lafayette Star Template  
For a 15" block

seam allowance

Place on fold of fabric

Lafayette Star Background  
1/4 circle

Place on fold of fabric

### Templates for Lafayette Star quilt

Shown at 100%

Designed by Debby Kratovil  
Quilted by Kathryn Gray